



4-point guide for correct fitting of MoliCare® Air Active all-in-one briefs

- Measure the waist and hips - use the larger size.
- Choose correct product size - if between sizes try the smaller size first.
- Open up the brief lengthways, leaving the non-woven side panels in folded position.
- Hold brief at each end and gently fold it lengthways once. This activates the inner cuffs and creates an anatomical 'cupped' shape for fitting.

1



- Place the 'cupped' brief between the thighs from the front - the soft white absorbent layer next to the skin and the absorbent area with tapes to the rear.
- Unfold rear absorbent area and fit snugly to the body.
- Wetness indicator should be in line with the spine. At the front, centre the absorbent cushion in the crotch area.

2

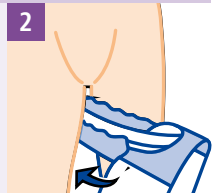

- Unfold front area and fit into position, as high as possible in the groin area.
- Unfold front side panels, fit snugly to the body and unfold side panels at the back.
- To fasten the brief, position the upper adhesive tapes at a slightly downwards angle onto side panel or backing.
- The lower adhesive tapes should point diagonally upwards.

3

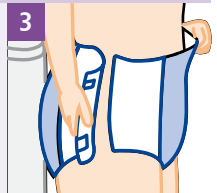

- Check that the brief is comfortably and closely fitted.
- When the stripes on the product are aligned, the super absorbent core is correctly positioned.
- To open and re-fasten the tapes, open the white tape only and re-fasten the white tape back onto the blue tape, which remains attached to the brief.

4

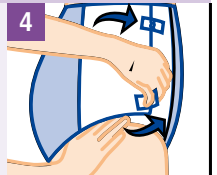

MoliCare® Air Active

MoliCare® Air Active all-in-one briefs are designed for clients with severe urinary and/or faecal incontinence. The breathable non-woven side panels and elasticised fixation tapes of MoliCare® Air Active ensure optimal client comfort.



Absorbency	Size	Waist/Hip Measurement	ISO Absorbency	Case Quantity	Product Code
------------	------	-----------------------	----------------	---------------	--------------

MoliCare® Air Active

Plus	S	60-90 cm	1370 ml	3 x 28	169 495
Plus	M	90-120 cm	1620 ml	3 x 28	169 695
Plus	L	120-150 cm	2020 ml	3 x 28	169 895
Extra	XS	40-60 cm	1621 ml	4 x 28	169 960
Extra	S	60-90 cm	1580 ml	3 x 28	169 961
Extra	M	90-120 cm	2070 ml	3 x 28	169 962
Extra	L	120-150 cm	2395 ml	3 x 28	169 963
Extra	XL	150-175 cm	4119 ml	4 x 14	169 904
Maxi	S	60-90 cm	1760 ml	3 x 28	169 484
Maxi	M	90-120 cm	2160 ml	3 x 28	169 684
Maxi	L	120-150 cm	2450 ml	3 x 28	169 884
Super	S	60-90 cm	1980 ml	3 x 28	169 971
Super	M	90-120 cm	2800 ml	3 x 28	169 972
Super	L	120-150 cm	3020 ml	3 x 28	169 973

MoliCare® Super Plus

Super Plus	S	50-80 cm	2143 ml	4 x 14	169 472
Super Plus	M	70-120 cm	3508 ml	4 x 14	169 672
Super Plus	L	100-150 cm	4598 ml	4 x 14	169 872

The use of oil-based or silicone-based creams, or talcum powder on the skin, may adversely affect the permeability of absorbent continence care products.

International Standard Method ISO 11948-1

PAUL HARTMANN LTD, Heywood Distribution Park, Pilsworth Road, Heywood, Lancashire OL10 2TT
Tel 01706 363200 Fax 01706 363201 Web www.hartmann.co.uk E-mail info@uk.hartmann.info